



GUILDFORD
BOROUGH

www.guildford.gov.uk

Tom Horwood
Joint Chief Executive
of Guildford and Waverley
Borough Councils

Contact Officer:

Sophie Butcher, Democratic Services
Officer

18 August 2023

Dear Councillor

Your attendance is requested at a meeting of the **LICENSING SUB COMMITTEE** to be held in the Council Chamber, Millmead House, Millmead, Guildford, Surrey GU2 4BB on **TUESDAY 29 AUGUST 2023** at **10.00 am**.

Yours faithfully

Tom Horwood
Joint Chief Executive

MEMBERS OF THE LICENSING SUB COMMITTEE

Councillor Catherine Young (Chairman)
Councillor Patrick Oven
Councillor David Shaw

QUORUM 3



THE COUNCIL'S STRATEGIC FRAMEWORK (2021- 2025)

Our Vision:

A green, thriving town and villages where people have the homes they need, access to quality employment, with strong and safe communities that come together to support those needing help.

Our Mission:

A trusted, efficient, innovative, and transparent Council that listens and responds quickly to the needs of our community.

Our Values:

- We will put the interests of our community first.
- We will listen to the views of residents and be open and accountable in our decision-making.
- We will deliver excellent customer service.
- We will spend money carefully and deliver good value for money services.
- We will put the environment at the heart of our actions and decisions to deliver on our commitment to the climate change emergency.
- We will support the most vulnerable members of our community as we believe that every person matters.
- We will support our local economy.
- We will work constructively with other councils, partners, businesses, and communities to achieve the best outcomes for all.
- We will ensure that our councillors and staff uphold the highest standards of conduct.

Our strategic priorities:

Homes and Jobs

- Revive Guildford town centre to unlock its full potential
- Provide and facilitate housing that people can afford
- Create employment opportunities through regeneration
- Support high quality development of strategic sites
- Support our business community and attract new inward investment
- Maximise opportunities for digital infrastructure improvements and smart places technology

Environment

- Provide leadership in our own operations by reducing carbon emissions, energy consumption and waste
- Engage with residents and businesses to encourage them to act in more environmentally sustainable ways through their waste, travel, and energy choices
- Work with partners to make travel more sustainable and reduce congestion
- Make every effort to protect and enhance our biodiversity and natural environment.

Community

- Tackling inequality in our communities
- Work with communities to support those in need
- Support the unemployed back into the workplace and facilitate opportunities for residents to enhance their skills
- Prevent homelessness and rough-sleeping in the borough

AGENDA

ITEM NO.

1 LOCAL CODE OF CONDUCT - DISCLOSABLE PECUNIARY INTERESTS

In accordance with the local Code of Conduct, a councillor is required to disclose at the meeting any disclosable pecuniary interest (DPI) that they may have in respect of any matter for consideration on this agenda. Any councillor with a DPI must not participate in any discussion or vote regarding that matter and that they must also withdraw from the meeting immediately before consideration of the matter.

If that DPI has not been registered, you must notify the Monitoring Officer of the details of the DPI within 28 days of the date of the meeting.

Councillors are further invited to disclose any non-pecuniary interest which may be relevant to any matter on this agenda, in the interests of transparency, and to confirm that it will not affect their objectivity in relation to that matter.

2 TO CONSIDER A NEW PREMISES LICENCE APPLICATION FOR PASTA EVANGELISTS, 176 HIGH STREET, GUILDFORD, GU1 3HW (Pages 7 - 32)

**Please contact us to request this document in an
alternative format**

LICENSING SUB-COMMITTEE

Application Type:	Application for a new Premises Licence	
Ward:	Castle Ward	Ward Councillors: Councillor Geoff Davis Councillor Richard Mills Councillor Maddy Redpath
Applicant:	Pasta Evangelists	
Premises:	176 High Street Guildford GU1 3HW	
	New premises licence application for the provision of late-night refreshment Monday – Sunday 23:00-02:00hrs The premises will operate as a delivery only business. The premises will not open to the public and will be used for the dispatch of goods only. There shall be no collection of goods by the public from the premises. (No selling or supplying alcohol)	

1. SITE LOCATION AND HISTORY

- 1.1 The premises is in a terraced building in the upper High Street Guildford.
- 1.2 There is a current live Premises Licence GUPLA0210 in place since November 2005 held by Art in Kuzina Limited.
- 1.3 A site location plan is attached at Appendix 1.
- 1.4 **The licensable activities under licence GUPLA0210 held by Amor Amora.**

Activities	Mon	Tues	Wed	Thurs	Fri	Sat	Sun
(1) Films							
(2) Live music							
	1000 - 0130	1000 - 0130	1000 - 0130	1000 - 0130	1000 - 0130	1000 - 0130	1000 - 0130
(3) Recorded music							
	1000 - 0130	1000 - 0130	1000 - 0130	1000 - 0130	1000 - 0130	1000 - 0130	1000 - 0130
(4) Performances of dance							

Activities	Mon	Tues	Wed	Thurs	Fri	Sat	Sun
(5) Late night refreshment							
	2300-0130	2300-0130	2300-0130	2300-0130	2300-0130	2300-0130	2300-0130
(7) Supply of alcohol							
	1000 - 0130	1000 - 0130	1000 - 0130	1000 - 0130	1000 - 0130	1000 - 0130	1000 - 0130
Times premises are open to public							
	1000 - 0200	1000 - 0200	1000 - 0200	1000 - 0200	1000 - 0200	1000 - 0200	1000 - 0200

2. APPLICATION

2.1 The application at Appendix 2.

2.2 Licensable activities:

- The provision of late-night refreshment.

2.3 Proposed hours:

The table below shows the licensable activities and requested hours as shown in the application form:

Activities	Mon	Tues	Wed	Thurs	Fri	Sat	Sun
(1) Films							
(2) Live music							
(3) Recorded music							
(4) Performances of dance							
(5) Late night refreshment							
	2300-0200	2300-0200	2300-0200	2300-0200	2300-0200	2300-0200	2300-0200
(7) Supply of alcohol							
Times premises are open to public							
	N/A	N/A	N/A	N/A	N/A	N/A	N/A

2.4 Promotion of the four licensing objectives

In relation to the licence application, the applicant has provided the following steps to promote the licensing objectives.

General:

The premises will operate as a delivery only business. The premises will not open to the public and will be used for the dispatch of goods only. There shall be no collection of goods by the public from the premises.

The prevention of crime and disorder:

All CCTV recordings made by the CCTV system shall be retained and stored in a suitable and secure manner for a minimum of 30 days. There shall be at least one camera positioned at each entry and exit point to monitor any external areas to the premises and of such quality to enable identification of the recorded person in any light.

Public safety:

The business will arrange for the telephone number for the premises and/or a member of the management team to be provided to residents upon request in order that any complaints can be made direct.

The prevention of public nuisance:

The premises will encourage all riders involved in deliveries to use their vehicles in a responsible manner so as not to cause a nuisance to any residents or generally gather outside the premises; (where vehicles have engines) not to leave engines running when the vehicles are parked; and not to obstruct the highway.

The protection of children from harm:

The business will arrange for the telephone number for the premises and/or a member of the management team to be provided to residents upon request in order that any complaints can be made direct.

2.5 Consultation period and advertisement of the application

The application was accepted as valid on 30th June 2023, with the consultation period running until 28th July 2023. The application was advertised by means of notices at the premises and a notice in the Surrey Advertiser in accordance with the regulations.

3. RELEVANT REPRESENTATIONS RECEIVED DURING CONSULTATION PERIOD

3.1 Representations from responsible authorities:

None were received.

3.2 Representations from other persons.

Two representations were received from other persons.

One has been withdrawn following confirmation of the proposed licenced activity.

One remains and is attached as Appendix 3.

4. LICENSING POLICY

The following sections of the Council's Licensing Policy are relevant:

Section 4: (Fundamental Principles)

Section 11: (Licensing Hours)

Section 12.1: (Prevention of Crime & Disorder)

Section 12.2: (Public Safety)

Section 12.3: (Prevention of Public Nuisance)

Section 12.4: (Protection of Children from Harm)

Section 17: (Licence Conditions).

5. NATIONAL GUIDANCE

The following sections of the Guidance issued in April 2018 by the Secretary of State under Section 182 of the Licensing Act 2003 are relevant:

Paragraph 1.16 - Licence conditions – General principles

Paragraph 1.17 – Each application on its own merits

Paragraphs 2.1-2.6 –Crime and Disorder

Paragraphs 2.7-2.14 – Public Safety

Paragraphs 2.15-2.21 – Public nuisance

Paragraphs 2.22-2.32 – Protection of children from harm

Paragraphs 9.31-9.41 – Hearings

Paragraphs 9.42-9.44 – Determining actions that are appropriate for the promotion of the licensing objectives

Paragraphs 10.1-10.66 – Conditions

6. MANDATORY CONDITIONS

Not applicable

7. RECOMMENDATION:

7.1 The Sub-Committee are requested to consider the application for the grant of a premises licence on its merits.

7.2 Subject to paragraph (7.3) below, Section 18(2) of the Licensing Act 2003 provides that the Sub-Committee must grant the application subject only to such conditions as are consistent with the operating schedule and the mandatory conditions.

7.3 Having regard to the relevant representation made during the consultation period, the Sub-Committee must take such steps (if any) as it considers appropriate for the promotion of the licensing objectives. The steps are:

- To impose additional conditions on the licence which are appropriate for the promotion of the licensing objectives, proportionate and which deal with the concerns of those making representations or
- To reject the application.

Originator:

Mark Adams

Licensing Compliance Officer

Tel: (01483) 444368

E-Mail: mark.adams@guildford.gov.uk

This page is intentionally left blank



Borough Boundary
N

Enter map title



© Guildford Borough Council

N Scale: 1:354

176 High Street, Guildford GU1
3HW

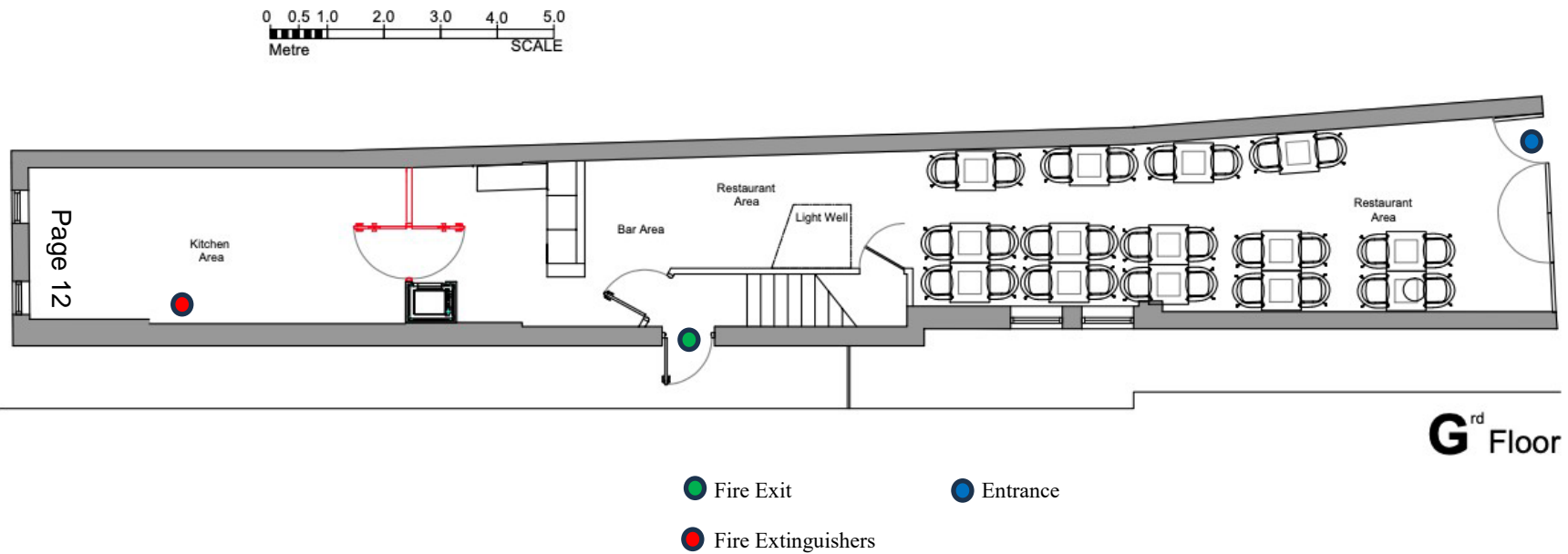

Grd Floor



Guildford
Application for a premises licence
Licensing Act 2003

For help contact
regulatoryservices@guildford.gov.uk
Telephone: 01483 505050

* required information

Section 1 of 21

You can save the form at any time and resume it later. You do not need to be logged in when you resume.

System reference

Not Currently In Use

This is the unique reference for this application generated by the system.

Your reference

You can put what you want here to help you track applications if you make lots of them. It is passed to the authority.

Are you an agent acting on behalf of the applicant?

- Yes No

Put "no" if you are applying on your own behalf or on behalf of a business you own or work for.

Applicant Details

* First name

* Family name

* E-mail

Main telephone number

Include country code.

Other telephone number

- Indicate here if you would prefer not to be contacted by telephone

Are you:

- Applying as a business or organisation, including as a sole trader
 Applying as an individual

A sole trader is a business owned by one person without any special legal structure. Applying as an individual means you are applying so you can be employed, or for some other personal reason, such as following a hobby.

Applicant Business

Is your business registered in the UK with Companies House?

- Yes No

Note: completing the Applicant Business section is optional in this form.

Registration number

10188849

Business name

Pasta Evangelists Limited

If your business is registered, use its registered name.

VAT number

GB 271685284

Put "none" if you are not registered for VAT.

Legal status

Private Limited Company

Continued from previous page...

Your position in the business

Home country

The country where the headquarters of your business is located.

Registered Address

Address registered with Companies House.

Building number or name

Street

District

City or town

County or administrative area

Postcode

Country

Section 2 of 21

PREMISES DETAILS

I/we, as named in section 1, apply for a premises licence under section 17 of the Licensing Act 2003 for the premises described in section 2 below (the premises) and I/we are making this application to you as the relevant licensing authority in accordance with section 12 of the Licensing Act 2003.

Premises Address

Are you able to provide a postal address, OS map reference or description of the premises?

- Address OS map reference Description

Postal Address Of Premises

Building number or name

Street

District

City or town

County or administrative area

Postcode

Country

Further Details

Telephone number

Non-domestic rateable value of premises (£)

Section 3 of 21

APPLICATION DETAILS

In what capacity are you applying for the premises licence?

- An individual or individuals
- A limited company / limited liability partnership
- A partnership (other than limited liability)
- An unincorporated association
- Other (for example a statutory corporation)
- A recognised club
- A charity
- The proprietor of an educational establishment
- A health service body
- A person who is registered under part 2 of the Care Standards Act 2000 (c14) in respect of an independent hospital in Wales
- A person who is registered under Chapter 2 of Part 1 of the Health and Social Care Act 2008 in respect of the carrying on of a regulated activity (within the meaning of that Part) in an independent hospital in England
- The chief officer of police of a police force in England and Wales

Confirm The Following

- I am carrying on or proposing to carry on a business which involves the use of the premises for licensable activities
- I am making the application pursuant to a statutory function
- I am making the application pursuant to a function discharged by virtue of His Majesty's prerogative

Section 4 of 21

NON INDIVIDUAL APPLICANTS

Provide name and registered address of applicant in full. Where appropriate give any registered number. In the case of a partnership or other joint venture (other than a body corporate), give the name and address of each party concerned.

Non Individual Applicant's Name

Name

Details

Registered number (where applicable)

Description of applicant (for example partnership, company, unincorporated association etc)

Continued from previous page...

Limited Company

Address

Building number or name	<input type="text" value="14"/>
Street	<input type="text" value="Bon Hill St"/>
District	<input type="text"/>
City or town	<input type="text" value="London"/>
County or administrative area	<input type="text" value="Greater London"/>
Postcode	<input type="text" value="EC2A4BX"/>
Country	<input type="text" value="United Kingdom"/>

Contact Details

E-mail	<input type="text" value="[REDACTED]"/>
Telephone number	<input type="text" value="[REDACTED]"/>
Other telephone number	<input type="text"/>
* Date of birth	<input type="text" value="[REDACTED]"/> / <input type="text" value="[REDACTED]"/> / <input type="text" value="[REDACTED]"/> dd mm yyyy
* Nationality	<input type="text" value="Italian"/> Documents that demonstrate entitlement to work in the UK

Section 5 of 21

OPERATING SCHEDULE

When do you want the premises licence to start?	<input type="text" value="28"/> / <input type="text" value="07"/> / <input type="text" value="2023"/> dd mm yyyy
If you wish the licence to be valid only for a limited period, when do you want it to end	<input type="text"/> / <input type="text"/> / <input type="text"/> dd mm yyyy

Provide a general description of the premises

For example the type of premises, its general situation and layout and any other information which could be relevant to the licensing objectives. Where your application includes off-supplies of alcohol and you intend to provide a place for consumption of these off- supplies you must include a description of where the place will be and its proximity to the premises.

Delivery only kitchen

Continued from previous page...

If 5,000 or more people are expected to attend the premises at any one time, state the number expected to attend

Section 6 of 21

PROVISION OF PLAYS

[See guidance on regulated entertainment](#)

Will you be providing plays?

- Yes No

Section 7 of 21

PROVISION OF FILMS

[See guidance on regulated entertainment](#)

Will you be providing films?

- Yes No

Section 8 of 21

PROVISION OF INDOOR SPORTING EVENTS

[See guidance on regulated entertainment](#)

Will you be providing indoor sporting events?

- Yes No

Section 9 of 21

PROVISION OF BOXING OR WRESTLING ENTERTAINMENTS

[See guidance on regulated entertainment](#)

Will you be providing boxing or wrestling entertainments?

- Yes No

Section 10 of 21

PROVISION OF LIVE MUSIC

[See guidance on regulated entertainment](#)

Will you be providing live music?

- Yes No

Section 11 of 21

PROVISION OF RECORDED MUSIC

[See guidance on regulated entertainment](#)

Will you be providing recorded music?

- Yes No

Section 12 of 21

PROVISION OF PERFORMANCES OF DANCE

[See guidance on regulated entertainment](#)

Will you be providing performances of dance?

Continued from previous page...

Section 13 of 21

PROVISION OF ANYTHING OF A SIMILAR DESCRIPTION TO LIVE MUSIC, RECORDED MUSIC OR PERFORMANCES OF DANCE

[See guidance on regulated entertainment](#)

Will you be providing anything similar to live music, recorded music or performances of dance?

- Yes No

Section 14 of 21

LATE NIGHT REFRESHMENT

Will you be providing late night refreshment?

- Yes No

Standard Days And Timings

MONDAY

Start

End

Start

End

Give timings in 24 hour clock.
(e.g., 16:00) and only give details for the days
of the week when you intend the premises
to be used for the activity.

TUESDAY

Start

End

Start

End

WEDNESDAY

Start

End

Start

End

THURSDAY

Start

End

Start

End

FRIDAY

Start

End

Start

End

SATURDAY

Start

End

Start

End

SUNDAY

Start

End

Start

End

Continued from previous page...

Will the provision of late night refreshment take place indoors or outdoors or both?

- Indoors Outdoors Both

Where taking place in a building or other structure tick as appropriate. Indoors may include a tent.

State type of activity to be authorised, if not already stated, and give relevant further details, for example (but not exclusively) whether or not music will be amplified or unamplified.

delivery only kitchen

State any seasonal variations

For example (but not exclusively) where the activity will occur on additional days during the summer months.

none

Non-standard timings. Where the premises will be used for the supply of late night refreshments at different times from those listed in the column on the left, list below

For example (but not exclusively), where you wish the activity to go on longer on a particular day e.g. Christmas Eve.

none

Section 15 of 21

SUPPLY OF ALCOHOL

Will you be selling or supplying alcohol?

- Yes No

PROPOSED DESIGNATED PREMISES SUPERVISOR CONSENT

How will the consent form of the proposed designated premises supervisor be supplied to the authority?

- Electronically, by the proposed designated premises supervisor
 As an attachment to this application

Reference number for consent form (if known)

If the consent form is already submitted, ask the proposed designated premises supervisor for its 'system reference' or 'your reference'.

Section 16 of 21

ADULT ENTERTAINMENT

Continued from previous page...

Highlight any adult entertainment or services, activities, or other entertainment or matters ancillary to the use of the premises that may give rise to concern in respect of children

Give information about anything intended to occur at the premises or ancillary to the use of the premises which may give rise to concern in respect of children, regardless of whether you intend children to have access to the premises, for example (but not exclusively) nudity or semi-nudity, films for restricted age groups etc gambling machines etc.

No matters ancillary to the premises

Section 17 of 21

HOURS PREMISES ARE OPEN TO THE PUBLIC

Standard Days And Timings

MONDAY

Start

End

Start

End

Give timings in 24 hour clock.
(e.g., 16:00) and only give details for the days
of the week when you intend the premises
to be used for the activity.

TUESDAY

Start

End

Start

End

WEDNESDAY

Start

End

Start

End

THURSDAY

Start

End

Start

End

FRIDAY

Start

End

Start

End

SATURDAY

Start

End

Start

End

SUNDAY

Start

End

Start

End

State any seasonal variations

For example (but not exclusively) where the activity will occur on additional days during the summer months.

Continued from previous page...

none
PLEASE NOTE: the hours stated in this section are only the trading hours, no members of the public has access to th premises. the kitchen is not open to any member of the public

Non standard timings. Where you intend to use the premises to be open to the members and guests at different times from those listed in the column on the left, list below

For example (but not exclusively), where you wish the activity to go on longer on a particular day e.g. Christmas Eve.

none

Section 18 of 21

LICENSING OBJECTIVES

Describe the steps you intend to take to promote the four licensing objectives:

a) General – all four licensing objectives (b,c,d,e)

List here steps you will take to promote all four licensing objectives together.

The premises will operate as a delivery only business. The premises will not open to the public and will be used for the dispatch of goods only. There shall be no collection of goods by the public from the premises.

b) The prevention of crime and disorder

All CCTV recordings made by the CCTV system shall be retained and stored in a suitable and secure manner for a minimum of 30 days. There shall be at least one camera positioned at each entry and exit point to monitor any external areas to the premises and of such quality to enable identification of the recorded person in any light.

c) Public safety

The business will arrange for the telephone number for the premises and/or a member of the management team to be provided to residents upon request in order that any complaints can be made direct.

d) The prevention of public nuisance

The premises will encourage all riders involved in deliveries to use their vehicles in a responsible manner so as not to cause a nuisance to any residents or generally gather outside the premises; (where vehicles have engines) not to leave engines running when the vehicles are parked; and not to obstruct the highway

e) The protection of children from harm

The business will arrange for the telephone number for the premises and/or a member of the management team to be provided to residents upon request in order that any complaints can be made direct

Continued from previous page...

Section 19 of 21

NOTES ON DEMONSTRATING ENTITLEMENT TO WORK IN THE UK

Entitlement to work/immigration status for individual applicants and applications from partnerships which are not limited liability partnerships:

A licence may not be held by an individual or an individual in a partnership who is resident in the UK who:

- does not have the right to live and work in the UK; or
- is subject to a condition preventing him or her from doing work relating to the carrying on of a licensable activity.

Any premises licence issued in respect of an application made on or after 6 April 2017 will become invalid if the holder ceases to be entitled to work in the UK.

Applicants must demonstrate that they have an entitlement to work in the UK and are not subject to a condition preventing them from doing work relating to the carrying on of a licensable activity. They do this in one of two ways: 1) by providing with this application copies or scanned copies of the documents listed below (which do not need to be certified), or 2) by providing their 'share code' to enable the licensing authority to carry out a check using the Home Office online right to work checking service (see below).

Documents which demonstrate entitlement to work in the UK

- An expired or current passport showing the holder, or a person named in the passport as the child of the holder, is A British citizen or a citizen of the UK and Colonies having the right of abode in the UK [please see note below about which sections of the passport to copy].
- An expired or current passport or national identity card showing the holder, or a person named in the passport as the child of the holder, is a national of a European Economic Area country or Switzerland.
- A Registration Certificate or document certifying permanent residence issued by the Home Office to a national of a European Economic Area country or Switzerland.
- A Permanent Residence Card issued by the Home Office to the family member of a national of a European Economic Area country or Switzerland.
- A **current** Biometric Immigration Document (Biometric Residence Permit) issued by the Home Office to the holder indicating that the person named is allowed to stay indefinitely in the UK, or has no time limit on their stay in the UK.
- A **current** passport endorsed to show that the holder is exempt from immigration control, is allowed to stay indefinitely in the UK, has the right of abode in the UK, or has no time limit on their stay in the UK.
- A **current** Immigration Status Document issued by the Home Office to the holder with an endorsement indicating that the named person is allowed to stay indefinitely in the UK or has no time limit on their stay in the UK, **when produced in combination with** an official document giving the person's permanent National Insurance number and their name issued by a Government agency or a previous employer.
- A birth or adoption certificate issued in the UK, **when produced in combination with** an official document giving the person's permanent National Insurance number and their name issued by a Government agency or a previous employer.
- A birth or adoption certificate issued in the Channel Islands, the Isle of Man or Ireland **when produced in combination with** an official document giving the person's permanent National Insurance number and their name issued by a Government agency or a previous employer.
- A certificate of registration or naturalisation as a British citizen, **when produced in combination with** an official document giving the person's permanent National Insurance number and their name issued by a Government agency or a previous employer.

Continued from previous page...

- A **current** passport endorsed to show that the holder is allowed to stay in the UK and is currently allowed to work and is not subject to a condition preventing the holder from doing work relating to the carrying on of a licensable activity.
- A **current** Biometric Immigration Document (Biometric Residence Permit) issued by the Home Office to the holder which indicates that the named person can currently stay in the UK and is allowed to work relation to the carrying on of a licensable activity.
- A **current** Residence Card issued by the Home Office to a person who is not a national of a European Economic Area state or Switzerland but who is a family member of such a national or who has derivative rights or residence.
- A **current** Immigration Status Document containing a photograph issued by the Home Office to the holder with an endorsement indicating that the named person may stay in the UK, and is allowed to work and is not subject to a condition preventing the holder from doing work relating to the carrying on of a licensable activity **when produced in combination with** an official document giving the person's permanent National Insurance number and their name issued by a Government agency or a previous employer.
- A Certificate of Application, **less than 6 months old**, issued by the Home Office under regulation 18(3) or 20(2) of the Immigration (European Economic Area) Regulations 2016, to a person who is not a national of a European Economic Area state or Switzerland but who is a family member of such a national or who has derivative rights of residence.
- Reasonable evidence that the person has an outstanding application to vary their permission to be in the UK with the Home Office such as the Home Office acknowledgement letter or proof of postage evidence, or reasonable evidence that the person has an appeal or administrative review pending on an immigration decision, such as an appeal or administrative review reference number.
- Reasonable evidence that a person who is not a national of a European Economic Area state or Switzerland but who is a family member of such a national or who has derivative rights of residence in exercising treaty rights in the UK including:-
 - evidence of the applicant's own identity – such as a passport,
 - evidence of their relationship with the European Economic Area family member – e.g. a marriage certificate, civil partnership certificate or birth certificate, and
 - evidence that the European Economic Area national has a right of permanent residence in the UK or is one of the following if they have been in the UK for more than 3 months:
 - (i) working e.g. employment contract, wage slips, letter from the employer,
 - (ii) self-employed e.g. contracts, invoices, or audited accounts with a bank,
 - (iii) studying e.g. letter from the school, college or university and evidence of sufficient funds; or
 - (iv) self-sufficient e.g. bank statements.

Family members of European Economic Area nationals who are studying or financially independent must also provide evidence that the European Economic Area national and any family members hold comprehensive sickness insurance in the UK. This can include a private medical insurance policy, an EHIC card or an S1, S2 or S3 form.

Original documents must not be sent to licensing authorities. If the document copied is a passport, a copy of the following pages should be provided:-

- (i) any page containing the holder's personal details including nationality;
- (ii) any page containing the holder's photograph;
- (iii) any page containing the holder's signature;
- (iv) any page containing the date of expiry; and
- (v) any page containing information indicating the holder has permission to enter or remain in the UK and is permitted to work.

Continued from previous page...

If the document is not a passport, a copy of the whole document should be provided.

Your right to work will be checked as part of your licensing application and this could involve us checking your immigration status with the Home Office. We may otherwise share information with the Home Office. Your licence application will not be determined until you have complied with this guidance.

Home Office online right to work checking service

As an alternative to providing a copy of the documents listed above, applicants may demonstrate their right to work by allowing the licensing authority to carry out a check with the Home Office online right to work checking service.

To demonstrate their right to work via the Home Office online right to work checking service, applicants should include in this application their 9-digit share code (provided to them upon accessing the service at <https://www.gov.uk/prove-right-to-work>) which, along with the applicant's date of birth (provided within this application), will allow the licensing authority to carry out the check.

In order to establish the applicant's right to work, the check will need to indicate that the applicant is allowed to work in the United Kingdom and is not subject to a condition preventing them from doing work relating to the carrying on of a licensable activity.

An online check will not be possible in all circumstances because not all applicants will have an immigration status that can be checked online. The Home Office online right to work checking service sets out what information and/or documentation applicants will need in order to access the service. Applicants who are unable to obtain a share code from the service should submit copy documents as set out above.

Section 20 of 21

NOTES ON REGULATED ENTERTAINMENT

Continued from previous page...

In terms of specific **regulated entertainments** please note that:

- Plays: no licence is required for performances between 08:00 and 23.00 on any day, provided that the audience does not exceed 500.
- Films: no licence is required for 'not-for-profit' film exhibition held in community premises between 08.00 and 23.00 on any day provided that the audience does not exceed 500 and the organiser (a) gets consent to the screening from a person who is responsible for the premises; and (b) ensures that each such screening abides by age classification ratings.
- Indoor sporting events: no licence is required for performances between 08.00 and 23.00 on any day, provided that the audience does not exceed 1000.
- Boxing or Wrestling Entertainment: no licence is required for a contest, exhibition or display of Greco-Roman wrestling, or freestyle wrestling between 08.00 and 23.00 on any day, provided that the audience does not exceed 1000. Combined fighting sports – defined as a contest, exhibition or display which combines boxing or wrestling with one or more martial arts – are licensable as a boxing or wrestling entertainment rather than an indoor sporting event.
- Live music: no licence permission is required for:
 - o a performance of unamplified live music between 08.00 and 23.00 on any day, on any premises.
 - o a performance of amplified live music between 08.00 and 23.00 on any day on premises authorised to sell alcohol for consumption on those premises, provided that the audience does not exceed 500.
 - o a performance of amplified live music between 08.00 and 23.00 on any day, in a workplace that is not licensed to sell alcohol on those premises, provided that the audience does not exceed 500.
 - o a performance of amplified live music between 08.00 and 23.00 on any day, in a church hall, village hall, community hall, or other similar community premises, that is not licensed by a premises licence to sell alcohol, provided that (a) the audience does not exceed 500, and (b) the organiser gets consent for the performance from a person who is responsible for the premises.
 - o a performance of amplified live music between 08.00 and 23.00 on any day, at the non-residential premises of (i) a local authority, or (ii) a school, or (iii) a hospital, provided that (a) the audience does not exceed 500, and (b) the organiser gets consent for the performance on the relevant premises from: (i) the local authority concerned, or (ii) the school or (iii) the health care provider for the hospital.
- Recorded Music: no licence permission is required for:
 - o any playing of recorded music between 08.00 and 23.00 on any day on premises authorised to sell alcohol for consumption on those premises, provided that the audience does not exceed 500.
 - o any playing of recorded music between 08.00 and 23.00 on any day, in a church hall, village hall, community hall, or other similar community premises, that is not licensed by a premises licence to sell alcohol, provided that (a) the audience does not exceed 500, and (b) the organiser gets consent for the performance from a person who is responsible for the premises.
 - o any playing of recorded music between 08.00 and 23.00 on any day, at the non-residential premises of (i) a local authority, or (ii) a school, or (iii) a hospital, provided that (a) the audience does not exceed 500, and (b) the organiser gets consent for the performance on the relevant premises from: (i) the local authority concerned, or (ii) the school proprietor or (iii) the health care provider for the hospital.

Continued from previous page...

- Dance: no licence is required for performances between 08.00 and 23.00 on any day, provided that the audience does not exceed 500. However, a performance which amounts to adult entertainment remains licensable.
- Cross activity exemptions: no licence is required between 08.00 and 23.00 on any day, with no limit on audience size for:
 - o any entertainment taking place on the premises of the local authority where the entertainment is provided by or on behalf of the local authority;
 - o any entertainment taking place on the hospital premises of the health care provider where the entertainment is provided by or on behalf of the health care provider;
 - o any entertainment taking place on the premises of the school where the entertainment is provided by or on behalf of the school proprietor; and
 - o any entertainment (excluding films and a boxing or wrestling entertainment) taking place at a travelling circus, provided that (a) it takes place within a moveable structure that accommodates the audience, and (b) that the travelling circus has not been located on the same site for more than 28 consecutive days.

Section 21 of 21

PAYMENT DETAILS

This fee must be paid to the authority. If you complete the application online, you must pay it by debit or credit card.

Premises Licence Fees are determined by the non domestic rateable value of the premises.

To find out a premises non domestic rateable value go to the Valuation Office Agency site at http://www.voa.gov.uk/business_rates/index.htm

Band A - No RV to £4300 £100.00

Band B - £4301 to £33000 £190.00

Band C - £33001 to £87000 £315.00

Band D - £87001 to £125000 £450.00*

Band E - £125001 and over £635.00*

*If the premises rateable value is in Bands D or E and the premises is primarily used for the consumption of alcohol on the premises then your are required to pay a higher fee

Band D - £87001 to £125000 £900.00

Band E - £125001 and over £1,905.00

There is an exemption from the payment of fees in relation to the provision of regulated entertainment at church halls, chapel halls or premises of a similar nature, village halls, parish or community halls, or other premises of a similar nature. The costs associated with these licences will be met by central Government. If, however, the licence also authorises the use of the premises for the supply of alcohol or the provision of late night refreshment, a fee will be required.

Schools and sixth form colleges are exempt from the fees associated with the authorisation of regulated entertainment where the entertainment is provided by and at the school or college and for the purposes of the school or college.

If you operate a large event you are subject to ADDITIONAL fees based upon the number in attendance at any one time

Capacity 5000-9999 £1,000.00

Capacity 10000 -14999 £2,000.00

Capacity 15000-19999 £4,000.00

Capacity 20000-29999 £8,000.00

Capacity 30000-39999 £16,000.00

Capacity 40000-49999 £24,000.00

Capacity 50000-59999 £32,000.00

Capacity 60000-69999 £40,000.00

Capacity 70000-79999 £48,000.00

Capacity 80000-89999 £56,000.00

Capacity 90000 and over £64,000.00

* Fee amount (£)

315.00

DECLARATION

Continued from previous page...

* I/we understand it is an offence, liable on conviction to a fine up to level 5 on the standard scale, under section 158 of the licensing act 2003, to make a false statement in or in connection with this application.

[Applicable to individual applicants only, including those in a partnership which is not a limited liability partnership] I understand I am not entitled to be issued with a licence if I do not have the entitlement to live and work in the UK (or if I am subject to a condition preventing me from doing work relating to the carrying on of a licensable activity) and that my licence will become invalid if I cease to be entitled to live and work in the UK (please read guidance note 15).

The DPS named in this application form is entitled to work in the UK (and is not subject to conditions preventing him or her from doing work relating to a licensable activity) and I have seen a copy of his or her proof of entitlement to work, if appropriate (please see note 15)

Ticking this box indicates you have read and understood the above declaration

This section should be completed by the applicant, unless you answered "Yes" to the question "Are you an agent acting on behalf of the applicant?"

* Full name

* Capacity

* Date / /
dd mm yyyy

Once you're finished you need to do the following:

1. Save this form to your computer by clicking file/save as...
2. Go back to <https://www.gov.uk/apply-for-a-licence/premises-licence/guildford/apply-1> to upload this file and continue with your application.

Don't forget to make sure you have all your supporting documentation to hand.

IT IS AN OFFENCE LIABLE TO SUMMARY CONVICTION TO A FINE OF ANY AMOUNT UNDER SECTION 158 OF THE LICENSING ACT 2003, TO MAKE A FALSE STATEMENT IN OR IN CONNECTION WITH THIS APPLICATION

IT IS AN OFFENCE UNDER SECTION 24B OF THE IMMIGRATION ACT 1971 FOR A PERSON TO WORK WHEN THEY KNOW, OR HAVE REASONABLE CAUSE TO BELIEVE, THAT THEY ARE DISQUALIFIED FROM DOING SO BY REASON OF THEIR IMMIGRATION STATUS. THOSE WHO EMPLOY AN ADULT WITHOUT LEAVE OR WHO IS SUBJECT TO CONDITIONS AS TO EMPLOYMENT WILL BE LIABLE TO A CIVIL PENALTY UNDER SECTION 15 OF THE IMMIGRATION, ASYLUM AND NATIONALITY ACT 2006 AND PURSUANT TO SECTION 21 OF THE SAME ACT, WILL BE COMMITTING AN OFFENCE WHERE THEY DO SO IN THE KNOWLEDGE, OR WITH REASONABLE CAUSE TO BELIEVE, THAT THE EMPLOYEE IS DISQUALIFIED

OFFICE USE ONLY

Applicant reference number	<input type="text"/>
Fee paid	<input type="text"/>
Payment provider reference	<input type="text"/>
ELMS Payment Reference	<input type="text"/>
Payment status	<input type="text"/>
Payment authorisation code	<input type="text"/>
Payment authorisation date	<input type="text"/>
Date and time submitted	<input type="text"/>
Approval deadline	<input type="text"/>
Error message	<input type="text"/>
Is Digitally signed	<input type="checkbox"/>

[1](#) [2](#) [3](#) [4](#) [5](#) [6](#) [7](#) [8](#) [9](#) [10](#) [11](#) [12](#) [13](#) [14](#) [15](#) [16](#) [17](#) [18](#) [19](#) [20](#) [21](#) [Next >](#)

From: [Clare Spacie](#)
To: [Regulatory Services](#)
Subject: Premises licence application Pasta Evangelists - High St Guildford
Date: 25 July 2023 09:11:57

I wish to object to the above application for a premises licence until 0200 every day. Even a delivery business will create noise and disruption and granting such a licence in this location in the centre of the ancient town also near to a number of flats would be out of character with the surrounding area. I believe the licence should not be extended beyond the original hours of 2300

Clare Spacie



 my iPad

This page is intentionally left blank